

## LKM113 FOR PT100/PT1000

The LKM113 is a digital configurable measuring transducer for Pt100/Pt1000 with a current output of 4...20 mA. The unit features 4 jumpers used to set 12 different measuring ranges. Smaller corrections can be made on-site using the zero-point controller. The sensor is connected with a 3/2 wire circuit.

The following measuring ranges can be configured:

-100..100°C	-20..150°C	0...300°C
-50..50°C	0..100°C	0...400°C
-40..60°C	0..150°C	0...500°C
-30..70°C	0..200°C	0...600°C



### TECHNISCHE DATEN

Input:	Pt100/Pt1000	Self- detecting
Overall measuring range:	-100..600°C	Pt1000 up to 300°C (adjustable via DIP-switch)
Measurement current :	0,25mA	
Power consumption:	max. 21mA	
Loop voltage:	10..35VDC	polarity - safe
Linearity error:	0.1 %FS	
Measuring accuracy:	0.3%	of the measuring range
Measuring rate:	2/s	
Output:	4..20mA	
Probe break:	>20mA	
Short-circuit:	<4mA	
Type of terminals:	screw connector	0,13..1,5mm <sup>2</sup>
Temperature coefficient:	<0.015K/°C	Set temperature range 0...100°C
Operating temperature range:	-40..85°C	
Dimension:	44.5x26.5mm	D x H
Weight:	32g	
EMC:	EN 61326-1:2006 EN 61326-2-3:2006	Emission and Interference Resistance

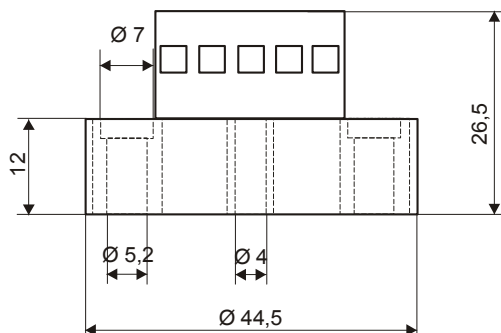

Load resistance

