

LKM114 FOR PT100/PT1000

The LKM114 is a digital configurable measuring transducer for Pt100/Pt1000 with a 0 to 10 V voltage output. Use 4 jumpers to set 12 different measuring ranges. Minor corrections can be carried out on site using the zero point controller. The sensor is connected with a 3-/2-lead circuit.

The following measuring ranges can be configured:

-100 .. 100 °C	-20 .. 150 °C	0 .. 300 °C
-50 .. 50 °C	0 .. 50 °C	0 .. 400 °C
-40 .. 60 °C	0 .. 100 °C	0 .. 500 °C
-30 .. 70 °C	0 .. 200 °C	0 .. 600 °C



TECHNICAL DATA

Input:	Pt100/Pt1000	Self- detecting
Overall measuring range:	-100 to 600°C	Pt1000 up to 300°C (adjustable via DIP-switch)
Measuring current:	0.25 mA	
Power consumption:	max. 10 mA	
Supply voltage:	15 to 35 VDC, 15..26 VAC	polarity - safe
Linearity error:	0.1% FS	
Measuring accuracy:	0.3 %	of measured range
Measuring rate:	2/s	
Output:	0 to 10 V	other output voltages possible
Probe break:	>10 V	
Short circuit:	0 V	
Clamping range:	Screw connectors	0.13 to 1.5 mm ²
Temperature coefficient:	<0.015 K/°C	set temperature range 0 to 100 °C
Operating temperature range:	-40 to 85 °C	
Dimension:	44,5 x 27 mm	W x H
Weight:	32 g	
EMC:	EN 61326-1:2006 EN 61326-2-3:2006	Emission and Resistance to Interference

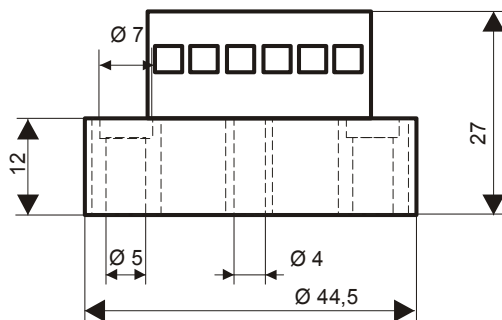

Load resistance

